

### Look for the ChargePass logo

Tap your new ChargePass™ card against the reader symbol on any charging station displaying the ChargePass logo:

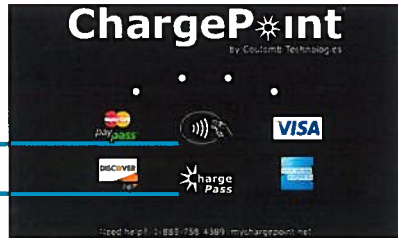

Reader Symbol

ChargePass Logo

**IMPORTANT!** You must use the same ChargePass card to start and stop a charging session.

If you see a ChargePoint charging station without the reader symbol, for example a home charging station, you won't need to use your ChargePass card.

### Two Types of Charging

**Level 1** Plug your own charging cord into the standard 120 V outlet located behind the station's locking door.

**Level 2** Plug the station's SAE J1772™ connector into your vehicle to charge at 240 V.



Level 1 station

Level 2 station

Dual-level station that can charge two vehicles at the same time (displays status for each level as #1 and #2)

Level 2 station

### Using your ChargePass card to charge your electric vehicle

#### Level 1 Charging

Use this method to charge at 120 V by plugging your own charging cord into the charging station's outlet.

##### To start a charging session:

1. Plug your charging cord into your electric vehicle.
2. Tap your ChargePass card on the station's reader symbol.

When your card is authorized, the station displays a message indicating the door is unlocked and you can insert the plug.

**IMPORTANT!** Cords with clear or transparent plugs will not work.

3. Lift the door and plug your charging cord into the socket.
4. Push the door closed to lock in place.

Charging begins when the door locks. The station displays a message indicating the vehicle is charging.

##### To stop a charging session:

1. Tap your ChargePass card on the station's reader symbol.
2. Remove your charging cord from the station's socket.
3. Push the door closed to lock in place.

**REMEMBER!** Remove your charging cord from your electric vehicle and take it with you.

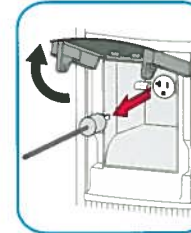
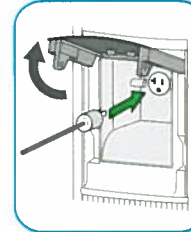

#### Level 2 Charging

Use this method to charge at 240 V by plugging the station's SAE J1772™ connector into your electric vehicle.

##### To start a charging session:

1. Tap your ChargePass card on the station's reader symbol.

When your card is authorized, the station displays a message indicating you can remove the connector from the holster and plug it into your electric vehicle.

2. Remove the charging station's connector by pressing down on the button at the top of the handle while pulling the connector from its holster. Plug the connector into your electric vehicle.

The station displays a message indicating the vehicle is charging.

##### To stop a charging session:

1. Tap your ChargePass card on the station's reader symbol.
2. Return the station's connector to its holster by pressing down on the button at the top of the handle while pulling the connector from your electric vehicle.

The station displays the charging duration and cost (if any) of your charging session.

